

PLAN 1/4" = 1'-0"

SECTION A--CL OF STRUCTURE 3/4" = 1'-0"

NOTE: RESCOM IS A SMALL DESIGN COMPANY OWNED BY KENT MCCOY--- PRIMARILY DOING ARCHITECTURAL AND SITE PLANNING UPGRADES FOR LOCAL BUILDERS

prepard by rescom design  
st george island fla-- phone 850 927 4897

PROPOSED CARPORT WITH ENCLOSURE---SUBMITTED BY BUILDERS BY THE SEA  
700 W PINE ST--ST GEORGE ISLAND FLA ph 850 927 3628

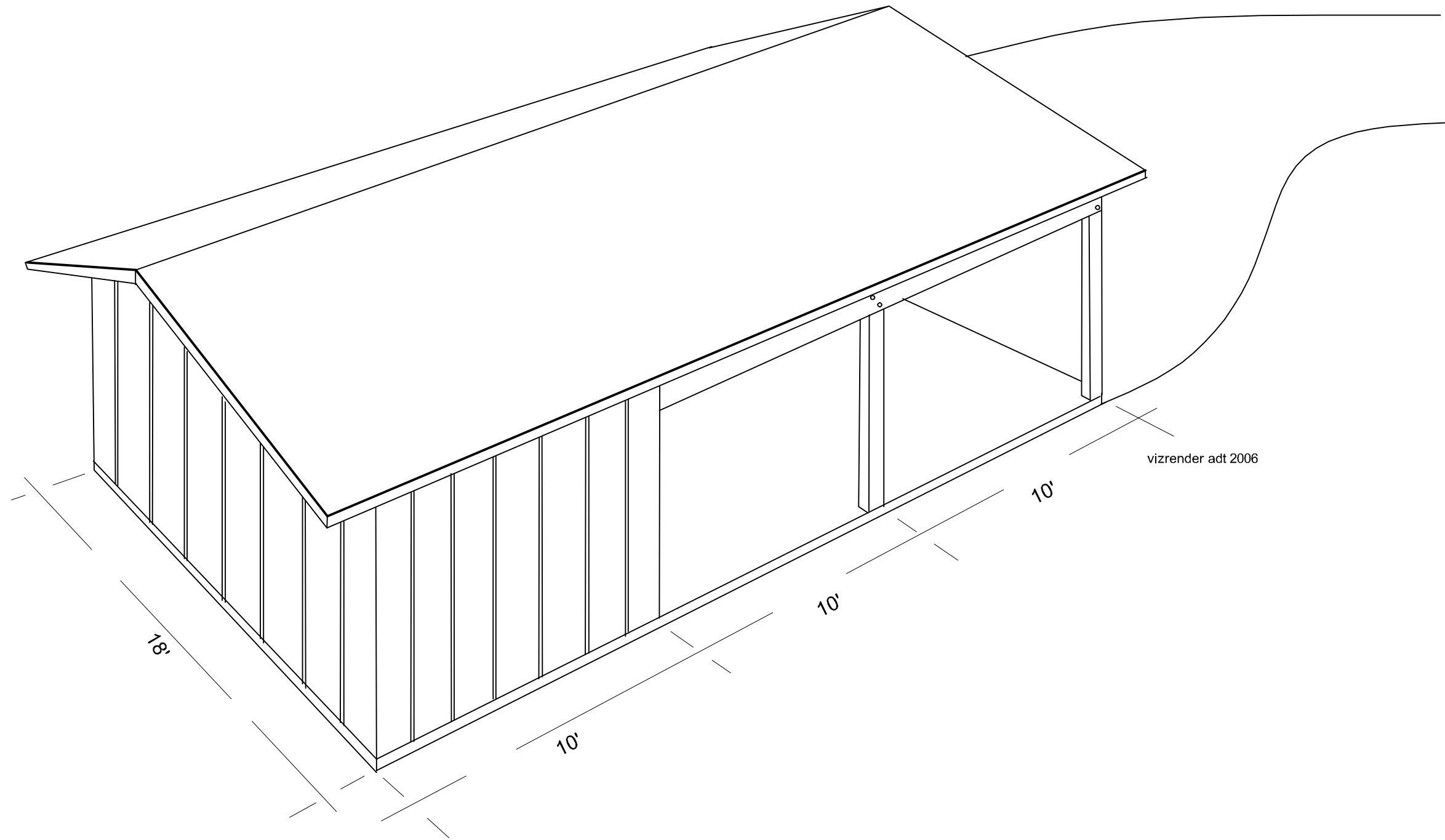

vizrender adt 2006

notes:

- 1-pressure treated schedule
- 6x6 columns
- base plate in enclosed area
- double 2x12 top band
- 2-roof decking is staggered 5/8 cdx plywood held with plywood clips per code spacing and blocked end segments
- 3-structure is code compliant with franklin county

<p>prepard by rescom design st george island fla-- phone 850 927 4897</p>	<p>PROPOSED CARPORT WITH ENCLOSURE---SUBMITTED BY BUILDERS BY THE SEA 700 W PINE ST--ST GEORGE ISLAND FLA PHONE 850 927 3628</p>
---	--